

LEGEND

●	FOUND 1" IRON PIPE
○	SET 1" IRON PIPE
---	EXISTING FENCE
⊙	UTILITY POLE
[Pattern]	EXISTING CONCRETE
[Pattern]	EXISTING GRAVEL DRIVE
[Pattern]	EXISTING BUILDING
[Pattern]	EXISTING DECK
[Pattern]	PROPOSED BUILDING
[Pattern]	PROPOSED DECK

PLAT OF SURVEY

A PARCEL OF LAND LOCATED IN THE SOUTHWEST 1/4 OF THE NORTHWEST 1/4 OF SECTION 28 IN TOWNSHIP 2 NORTH, RANGE 17 EAST, IN THE TOWN OF GENEVA, WALWORTH COUNTY, WISCONSIN.

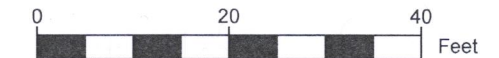

SCALE: 1"=20'

NOTE:

1. BASIS OF BEARING: THE WISCONSIN STATE PLANE COORDINATE SYSTEM, NAD-83, SOUTH ZONE.
2. FIELD WORK COMPLETED AUGUST 26, 2020
3. FIELD CREW CHIEF: LOGAN RANDLE
4. BUILDING SURVEYED TO THE EXTERIOR OF SIDING.

LEGAL DESCRIPTION:

A PARCEL OF LAND LOCATED IN THE SOUTHWEST 1/4 OF THE NORTHWEST 1/4 OF SECTION 28 IN TOWNSHIP 2 NORTH, RANGE 17 EAST, IN THE TOWN OF GENEVA, WALWORTH COUNTY, WISCONSIN, MORE PARTICULARLY DESCRIBED AS:

LOTS 10473 THRU 10476 BLK 190 OF THE LAKE COMO BEACH FIFTH MAP AS RECORDED ON DOCUMENT # P255834 IN THE WALWORTH COUNTY REGISTER OF DEEDS.

SURVEY ORDERED BY:

RAMIRO CHAVEZ

PROPERTY ADDRESS:

N3171 TAMARACK ROAD,
LAKE GENEVA, WISCONSIN 53147

SURVEYOR:

PAUL H. VAN HENKELUM, PLS
CARDINAL ENGINEERING LLC

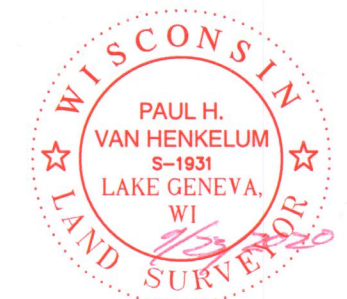
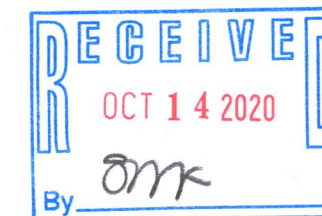

"I HEREBY CERTIFY THAT I HAVE SURVEYED THE ABOVE DESCRIBED PROPERTY AND THE MAP IS A TRUE AND CORRECT REPRESENTATION OF ITS EXTERIOR BOUNDARIES AND SHOWS THE SIZE AND LOCATION OF ALL VISIBLE STRUCTURES, APPARENT EASEMENTS AND ENCROACHMENTS, IF ANY."

Paul H. Van Henkelum
PAUL H. VAN HENKELUM, PLS #1931 DATE 9/23/2020



CARDINAL ENGINEERING LLC
DESIGNING IN TRUE DIRECTIONS

PO BOX 281 - 1200 LA SALLE ST.
LAKE GENEVA, WI 53147
262-757-8776
CARDINALENGINEERINGWI.COM

DATE: 9/23/2020 JOB No. 20445
SHEET 1 OF 1

JLCB-2270

217-4695